

# KALEIDO

## Professional ventilated gelato display

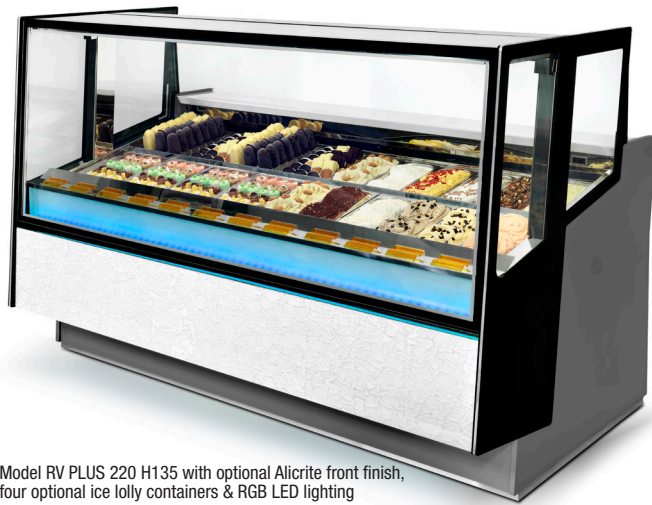

Model RV PLUS 220 H135 with optional Alicrite front finish, four optional ice lolly containers & RGB LED lighting



Model RV PLUS 170 H117 with optional Vetro Rosso front finish



ITEM No. \_\_\_\_\_

### Model options:

(PLUS - SINGLE EVAPORATOR, DUAL FRONT AIRFLOW)

KALEIDO RV PLUS 120

KALEIDO RV PLUS 170

KALEIDO RV PLUS 220



PLUS

(PLUS 1 - DUAL EVAPORATOR, SINGLE REAR AIRFLOW)

KALEIDO RV PLUS 1 120

KALEIDO RV PLUS 1 170

KALEIDO RV PLUS 1 220



PLUS 1

(PLUS 2 - DUAL EVAPORATOR, DUAL REAR AIRFLOW)

KALEIDO RV PLUS 2 120

KALEIDO RV PLUS 2 170

KALEIDO RV PLUS 2 220



PLUS 2

ALL models listed above are available either H117 or H135 high

### Standard equipment:

Cool white LED lighting 5700 K°

Work top - Glacier White Corian™

Front panel - Black back-painted glass

Lower front grill - Grey (RAL9007)

Side panels - Grey (RAL9007) lacquered

Plexiglass sliding doors

Adjustable air deflectors (PLUS 1&2 ONLY)

Swivel castors with brake & adjustable feet

### Optional extras:

5 Lt standard Napoli pan (S/S)

5 Lt wide Napoli pan (S/S) (360x250x80h mm)

Self rolling night curtain

RGB LED lighting behind front panel

Cone holder with/without toppings container

Scoop wash with shower or tap

Ice lolly container (250x360x43h mm)

Tray for individual portions (250x360 mm)

Stainless steel tray kits

Dual temperature function (call for details)

Remote refrigeration installation (call for details)

Front panel finishes - Vetro Rosso  
Pelli Di Struzzo  
Alicrite

### Features:

- ◆ Ice cream display with ventilated refrigeration with dual airflow for perfect temperature distribution. One piece body insulated with ecological polyurethane (HCFC & HFC free) CO2 foam, 60 mm thick.
- ◆ Kaleido can be set up with three different types of ventilation: PLUS single evaporator with frontal dual airflow; PLUS 1 dual evaporator with single rear air flow; PLUS 2 dual evaporator with dual rear air flow.
- ◆ Double glazed heated front glass opens via top mounted hydraulic pistons. Aesthetic side panels made of laminate and lacquered on the lower part, double glazed heated glass on the upper section. Interior light with triple LED strip. Structure base in, epoxy powder-coated carbon steel with rotating castors. Control panel with electronic control unit, located on lower part of operator's side. Digital thermometer placed inside the well.



**ENERGY SAVING**  
LED lights + EC fan motor



**REFRIGERATION**  
Ventilated



**DEFROST**  
Reverse cycle



**REFRIGERANT**  
R290 - PLUS  
R452A - PLUS 1 & PLUS 2



**INSTALLATION**  
Plug-In / Remote (optional)



**TEMPERATURE**  
-20 / +2 °C



**CLIMATE CLASS**  
7 - PLUS  
4 - PLUS 1 & PLUS 2



**ENERGY RATING**  
E



**Taylor UK** (a division of HTG Trading Ltd)  
106 Claydon Business Park, Gt. Blakenham,  
Ipswich, Suffolk, IP6 0NL, United Kingdom  
**0800 838 896 - sales@taylor-company.co.uk**  
**www.taylor-company.co.uk**

Due to continual research and development, these specifications are subject to change without notification.

March 2021

## Professional ventilated gelato display

Section view: (all dimensions in mm)



**H117**

Single evaporator with frontal dual airflow  
Display inclination 11°



**PLUS 1**

Dual evaporator with single rear airflow  
Display inclination 3°



**PLUS 2**

Dual evaporator with dual rear airflow  
Display inclination 0°

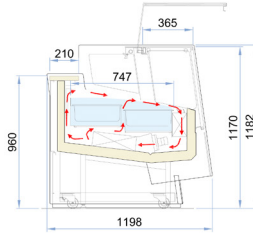
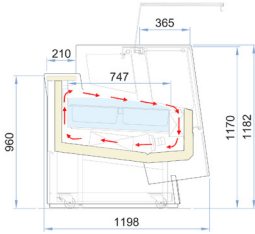
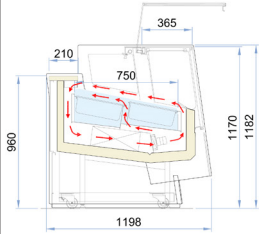

ITEM No. \_\_\_\_\_

Napoli configuration:

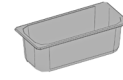

5 Lt (STD)  
360 x 165 x 120(h) mm

Display

Model 120  
Model 170  
Model 220

12  
18  
24

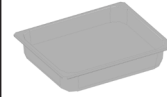

5/10 Lt (WIDE)  
360 x 250 x 80/120(h) mm

Display

Model 120  
Model 170  
Model 220

8  
12  
16



**H135**

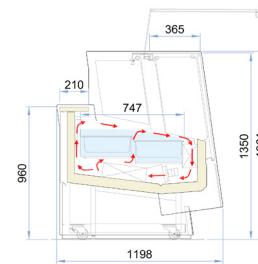
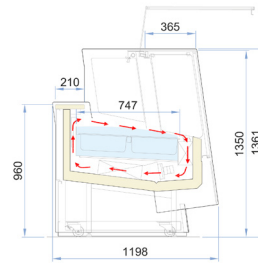

KALEIDO		Model type	Display area m <sup>2</sup>	Temp class	Recomm. temp °C	Energy class	Energy Efficiency Index	Annual Energy kWh/A
H117 PLUS	Height	IGF1	0.71	G2	-15 °C	E (R290)	49.26	8,391
	Length	IGF1	1.07	G2	-15 °C	E (R290)	53.20	11,165
		IGF1	1.43	G2	-15 °C	E (R290)	53.55	13,358
H135 PLUS	Height	IGF1	0.71	G2	-15 °C	E (R290)	55.43	8,726
	Length	IGF1	1.07	G2	-15 °C	E (R290)	51.22	11,634
		IGF1	1.43	G2	-15 °C	E (R290)	55.97	13,961
H117 PLUS 1 PLUS 2	Height	IGF1	0.71	G2	-15 °C	E (R452A)	54.51	9,285
	Length	IGF1	1.07	G2	-15 °C	E (R452A)	58.86	12,355
		IGF1	1.43	G2	-15 °C	E (R452A)	59.26	14,782
H135 PLUS 1 PLUS 2	Height	IGF1	0.71	G2	-15 °C	E (R452A)	61.34	9,656
	Length	IGF1	1.07	G2	-15 °C	E (R452A)	56.68	12,874
		IGF1	1.43	G2	-15 °C	E (R452A)	61.94	15,449

Configuration: air cooled plug-in unit (R452A or R290) plexiglass sliding door closure, LED lighting

KALEIDO*	RV 120	RV 170	RV 220
External dimensions (LxDxH) <b>H117</b>	1182 x 1198 x 1182 mm	1677 x 1198 x 1182 mm	2172 x 1198 x 1182 mm
External dimensions (LxDxH) <b>H135</b>	1182 x 1198 x 1362 mm	1677 x 1198 x 1362 mm	2172 x 1198 x 1362 mm
Net weight <b>H117</b>	320 kg	409 kg	510 kg
Net weight <b>H135</b>	346 kg	434 kg	535 kg
Refrigeration	Ventilated		
Refrigerant	R290 PLUS ONLY (R452A PLUS 1 & 2)		
Climate class - PLUS	7		
Climate class - PLUS 1 & 2	4		
Operating conditions - PLUS	35 °C / 75 %RH		
Operating conditions - PLUS 1 & 2	30 °C / 55 %RH		
Operating temperature range	-20 / +2 °C		
Product storage temperature	-16 / -14 °C		
Compressor (no. - type)	1 - Hermetic	2 - Hermetic	
Defrost process	Reverse cycle		
Power supply voltage	230v / 50hz / 1ph	400v / 50hz / 3ph	
Electrical input (nominal)	1240 w / 6.0 A	1720 w / 3.0 A	2700 w / 4.2 A
Electrical input (defrost)	2300 w / 11.0 A	2950 w / 4.9 A	6300 w / 8.5 A

Taylor UK (a division of HTG Trading Ltd)

106 Claydon Business Park, Gt. Blakenham, Ipswich, Suffolk, IP6 0NL, United Kingdom

0800 838 896 - sales@taylor-company.co.uk

www.taylor-company.co.uk

**Taylor UK**  
Catering Equipment Specialists

Due to continual research and development, these specifications are subject to change without notification.



# KALEIDO DUAL ZONE



Twin zone professional gelato display



Model RV PLUS 170+50 H135  
with optional Alicrite front finish & RGB LED lighting



Model RV PLUS 120+50 H117 with optional Vetro Rosso front finish

ITEM No. \_\_\_\_\_

## Model options:

(PLUS - SINGLE EVAPORATOR, DUAL FRONT AIRFLOW)

KALEIDO RV PLUS 120+50

KALEIDO RV PLUS 170+50



ALL models listed above are available either H117 or H135 high

## Standard equipment:

Cool white LED lighting 5700 K°

Work top - Glacier White Corian™

Front panel - Black back-painted glass

Lower front grill - Grey (RAL9007)

Side panels - Grey (RAL9007) lacquered

Plexiglass sliding doors

Swivel castors with brake & adjustable feet

## Optional extras:

5 Lt standard Napoli pan (S/S)

5 Lt wide Napoli pan (S/S) (360x250x80h mm)

Self rolling night curtain

RGB LED lighting behind front panel

Cone holder with/without toppings container

Scoop wash with shower or tap

Ice lolly container (250x360x43h mm)

Tray for individual portions (250x360 mm)

Stainless steel tray kits

Remote refrigeration installation (call for details)

Front panel finishes - Vetro Rosso

Pelli Di Struzzo

Alicrite

## Features:

- ♦ Ice cream display with ventilated refrigeration with dual airflow for perfect temperature distribution. One piece body insulated with ecological polyurethane (HCFC & HFC free) C02 foam, 60 mm thick.
- ♦ Kaleido dual zone display cabinets are only available with PLUS single evaporator with frontal dual airflow. Dual zone allows two different products to be displayed at two different temperatures.
- ♦ Double glazed heated front glass opens via top mounted hydraulic pistons. Aesthetic side panels made of laminate and lacquered on the lower part, double glazed heated glass on the upper section. Interior light with triple LED strip. Structure base in, epoxy powder-coated carbon steel with rotating castors. Control panel with electronic control unit, located on lower part of operator's side. Digital thermometer placed inside the well.



**ENERGY SAVING**  
LED lights + EC fan motor



**REFRIGERATION**  
Ventilated



**DEFROST**  
Reverse cycle



**REFRIGERANT**  
R290



**INSTALLATION**  
Plug-In / Remote (optional)



**TEMPERATURE**  
-20 / +2 °C



**CLIMATE CLASS**  
7 - PLUS



**ENERGY RATING**  
E



Sistema di Qualità  
**ISO 9001**  
Cert. CISQ/CSQ 9130.TAIF



Sistema di Qualità  
**ISO 14001**  
Cert. CIS ECO ISO 9191.ISA3

aria **ISO 14064**



**Taylor UK**  
Catering Equipment Specialists

**Taylor UK** (a division of HTG Trading Ltd)  
106 Claydon Business Park, Gt. Blakenham,  
Ipswich, Suffolk, IP6 0NL, United Kingdom  
**0800 838 896 - sales@taylor-company.co.uk**  
**www.taylor-company.co.uk**

Due to continual research and development, these specifications are subject to change without notification.

March 2021

KALEIDO DUAL ZONE - Twin zone professional gelato display - 18/24 flavour

# KALEIDO DUAL ZONE



## Twin zone professional gelato display

Section view: (all dimensions in mm)

**H117**



Single evaporator with frontal dual airflow  
Display inclination 11°

**H135**

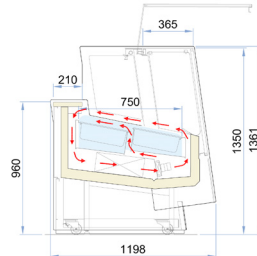
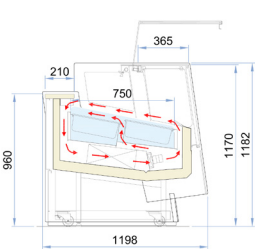

ITEM No. \_\_\_\_\_

Napoli configuration:

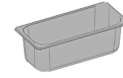

5 Lt (STD)  
360 x 165 x 120(h) mm

Display

Model 120+50

6+12

Model 170+50

6+18

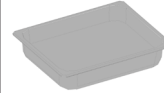

5/10 Lt (WIDE)  
360 x 250 x 80/120(h) mm

Display

Model 120+50

4+8

Model 170+50

4+12

KALEIDO - Dual Zone		Model type	Display area m <sup>2</sup>	Temp class	Reccom. temp °C	Energy class	Energy Efficiency Index	Annual Energy kWh/A
Height	Length							
H117 PLUS	120+50	IGF1	1.07	G2	-15 °C	E (R290)	53.20	11,165
	170+50	IGF1	1.43	G2	-15 °C	E (R290)	54.60	13,620
H135 PLUS	120+50	IGF1	1.07	G2	-15 °C	E (R290)	56.52	11,863
	170+50	IGF1	1.43	G2	-15 °C	E (R290)	57.07	14,235

Configuration: air cooled plug-in unit (R290) plexiglass sliding door closure, LED lighting

KALEIDO - DUAL ZONE*	RV 120+50	RV 170+50
External dimensions (LxDxH) <b>H117</b>	1677 x 1198 x 1182 mm	2172 x 1198 x 1182 mm
External dimensions (LxDxH) <b>H135</b>	1677 x 1198 x 1362 mm	2172 x 1198 x 1362 mm
Net weight <b>H117</b>	409 kg	510 kg
Net weight <b>H135</b>	434 kg	535 kg
Refrigeration	Ventilated	
Refrigerant	R290	
Climate class - <b>PLUS</b>	7	
Operating conditions - <b>PLUS</b>	35 °C / 75 %RH	
Operating temperature range	-20 / +2 °C Dual Zone	
Product storage temperature	-16 / -14 °C Dual Zone	
Compressor (no. - type)	2 - Hermetic	
Defrost process	Reverse cycle	
Power supply voltage	400v / 50hz / 3ph	
Electrical input (nominal)	1720 w / 3.0 A	2700 w / 4.2 A
Electrical input (defrost)	2950 w / 4.9 A	6300 w / 8.5 A



Sistema di Qualità  
**ISO 9001**  
Cert. CISQ/CSQ 9130.TAIF



Sistema di Qualità  
**ISO 14001**  
Cert. CIS ECO ISO 9191.ISA3



Taylor UK (a division of HTG Trading Ltd)

106 Claydon Business Park, Gt. Blakenham,  
Ipswich, Suffolk, IP6 0NL, United Kingdom

0800 838 896 - sales@taylor-company.co.uk

www.taylor-company.co.uk

Due to continual research and development, these specifications are subject to change without notification.

\*Data for air cooled units. Water cooled and remote installations are available on request.