

# ONESHOW BASE

High visibility free-standing display cabinets

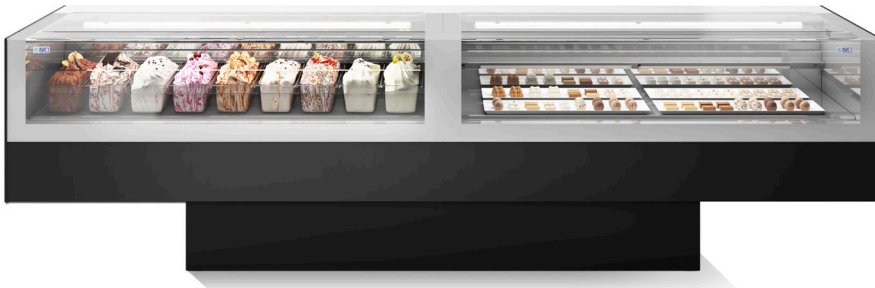

Model ONESHOW BASE GELATO RV 170+170 with Napoli fitting kit, optional DUAL TEMP operation (call for details) and optional black painted basement



ITEM No. \_\_\_\_\_

**Model options:**

GELATO (with standard Napoli or Carapine configurations)

- ONESHOW BASE GELATO RV 120+120
- ONESHOW BASE GELATO RV 170+170

Chilled PASTRY

- ONESHOW BASE PAS RV 120+120
- ONESHOW BASE PAS RV 170+170

Specialist cabinet with humidity control for CHOCOLATE

- ONESHOW BASE CHOC RV 120+120
- ONESHOW BASE CHOC RV 170+170

**Standard equipment:**











- Fitting kit for either Napolis or Carapines (Gelato only)
- Tray kit (pastry & chocolate only)
- Cool white LED lighting 5700 K°
- Work top - Glacier White Corian™
- Front panel - Alaska White 0030 Fenix™
- Basement - Alaska White 0030 Fenix™
- Side panels - Alaska White 0030 Fenix™
- Adjustable feet

**Optional extras:**

- 5 ltr standard napoli (Polycarbonate)
- 5 ltr wide napoli (Polycarbonate) (360x250x80h mm)
- 3 ltr carapine (Polycarbonate) (154x160h mm)
- Ice lolly container (250x360x43h mm)
- Tray for individual portions (250x360 mm)
- Dual temperature function (call for details)
- Remote refrigeration installation (call for details)
- Front & side panel colours - White printed glass  
Wood finishes
- Basement colour - 304 Stainless steel  
Black painted sheet (RAL9005)  
Castle White printed glass (RAL9003)

**Features:**

- ◆ OneShow - A showcase that can do everything; gelato, frozen pastry items, ice lolly display, chilled pastries and chocolate.
- ◆ Stratified glass structures are heated to help prevent condensation build up.
- ◆ Available in a range of premium standard finished and wood effects are available on request.
- ◆ Free-standing design for maximum visual impact.

 <p><b>ENERGY SAVING</b> LED lights + EC fan motor</p>	 <p><b>REFRIGERATION</b> Ventilated</p>	 <p><b>DEFROST</b> Reverse cycle - Gelato Off cycle - Pastry/Chocolate</p>	 <p><b>REFRIGERANT</b> R404A</p>
 <p><b>INSTALLATION</b> Plug-In / Remote (optional)</p>	 <p><b>TEMPERATURE</b> -20 / +2 °C - Gelato +1 / +10 °C - Pastry +14 / +16 °C - Chocolate</p>	 <p><b>CLIMATE CLASS</b> 4 - Gelato 3 - Pastry/Chocolate</p>	
 Sistema di Qualità <b>ISO 9001</b> <small>Cert. CISQ/CSQ 9130.TAIF</small>	 Sistema di Qualità <b>ISO 14001</b> <small>Cert. CIS ECO ISO 9191.ISA3</small>	 <b>Taylor UK</b> (a division of HTG Trading Ltd) 106 Claydon Business Park, Gt. Blakenham, Ipswich, Suffolk, IP6 ONL, United Kingdom <b>0800 838 896 - sales@taylor-company.co.uk</b> <b>www.taylor-company.co.uk</b>	
		Due to continual research and development, these specifications are subject to change without notification - June 2019	

ONESHOW BASE - High visibility free-standing display cabinets - 12/18 flavour

# ONESHOW BASE



## High visibility free-standing display cabinets

Section view: (all dimensions in mm)

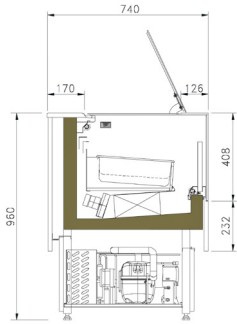

**L120+120 Gelato - Napoli**

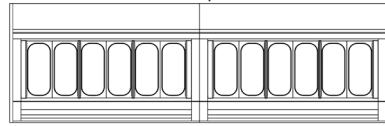

**L170+170**

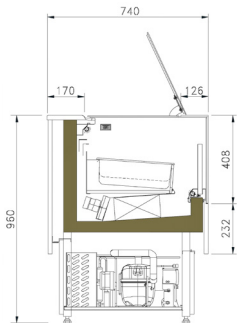
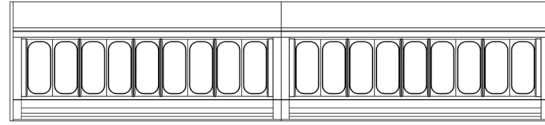

**L120+120 Gelato - Carapine**

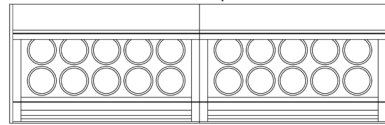

**L170+170**

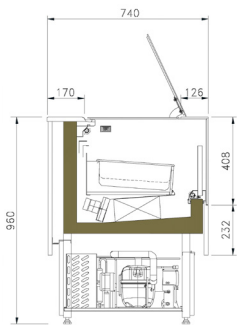
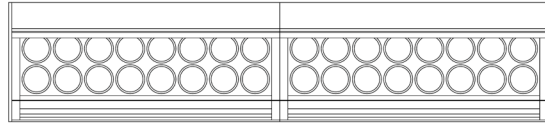

**L120+120 Pastry & Chocolate**



**L170+170**

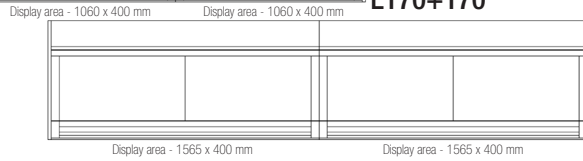

ITEM No. \_\_\_\_\_

### Napoli configuration:

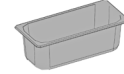

**5 ltr (STD Polycarbonate)**  
360 x 165 x 120(h) mm

#### Display

Model 120+120 6+6  
Model 170+170 9+9

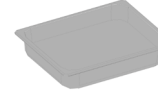

**5 ltr (WIDE Polycarbonate)**  
360 x 250 x 80(h) mm

#### Display

Model 120+120 4+4  
Model 170+170 6+6

### Carapine configuration:



**3 ltr (Polycarbonate)**  
154 x 160(h) mm

#### Display

Model 120+120 10+10  
Model 170+170 16+16

ONESHOW BASE – High visibility free-standing display cabinets - 12/18 flavour

### ONESHOW BASE\*

	GELATO		PASTRY		CHOCOLATE	
	RV 120+120	RV 170+170	PAS RV 120+120	PAS RV 170+170	CHOC RV 120+120	CHOC RV 170+170
External dimensions (LxDxH)	2360 x 740 x 960 mm	3370 x 740 x 960 mm	2360 x 740 x 960 mm	3370 x 740 x 960 mm	2360 x 740 x 960 mm	3370 x 740 x 960 mm
Net weight	380 kg	510 kg	380 kg	510 kg	380 kg	510 kg
Refrigeration	Ventilated					
Refrigerant	R404A					
Climate class	4		3			
Operating conditions	30 °C / 55 %RH		25 °C / 60 %RH			
Operating temperature range	-20 / +2 °C		n/a		n/a	
Product storage temperature	-16 / -14 °C		+1 / +10 °C		+14 / +16 °C	
Compressor (no. - type)	2 - Hermetic					
Defrost process	Reverse cycle			Off cycle		
Power supply voltage	230v / 50hz / 1ph					
Electrical input (nominal)	2000 w / 10.2 A	3300 w / 15.6 A	1720 w / 10.8 A	2000 w / 11.2 A	1720 w / 10.8 A	2000 w / 11.2 A
Electrical input (defrost)	3400 w / 16.0 A	7000 w / 31.2 A	140 w / 0.8 A	160 w / 0.9 A	140 w / 0.8 A	160 w / 0.9 A



Sistema di Qualità  
**ISO 9001**  
Cert. CISQ/CISQ 9130.TAIF



Sistema di Qualità  
**ISO 14001**  
Cert. CIS ECO ISO 9191.ISA3



\*Data for air cooled units. Water cooled and remote installations are available on request.



**Taylor UK** (a division of HTG Trading Ltd)  
106 Claydon Business Park, Gt. Blakenham,  
Ipswich, Suffolk, IP6 0NL, United Kingdom  
**0800 838 896 - sales@taylor-company.co.uk**  
**www.taylor-company.co.uk**

Due to continual research and development, these specifications are subject to change without notification - June 2019