

# ONESHOW BASE

High visibility free-standing display cabinets

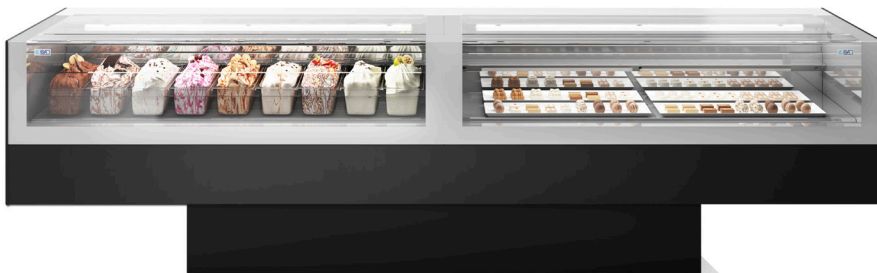

Model ONESHOW BASE GELATO RV 170+170  
with Napoli fitting kit, optional DUAL TEMP operation (call for details)  
and optional black painted basement



ITEM No. \_\_\_\_\_

## Model options:

GELATO (with standard Napoli or Carapine configurations)

- ONESHOW BASE GELATO RV 120+120
- ONESHOW BASE GELATO RV 170+170

Chilled PASTRY

- ONESHOW BASE PAS RV 120+120
- ONESHOW BASE PAS RV 170+170

Specialist cabinet with humidity control for CHOCOLATE

- ONESHOW BASE CHOC RV 120+120
- ONESHOW BASE CHOC RV 170+170

## Standard equipment:

- Fitting kit for either Napoli or Carapine pans (Gelato only)
- Tray kit (pastry & chocolate only)
- Cool white LED lighting 5700 K°
- Work top - Glacier White Corian™
- Front panel - Alaska White 0030 Fenix™
- Basement - Alaska White 0030 Fenix™
- Side panels - Alaska White 0030 Fenix™
- Adjustable feet

## Optional extras:

- 5 Lt standard Napoli pan (Polycarbonate)
- 5 Lt wide Napoli pan (Polycarbonate) (360x250x80h mm)
- 3 Lt carapine pan (Polycarbonate) (154x160h mm)
- Ice lolly container (250x360x43h mm)
- Tray for individual portions (250x360 mm)
- Dual temperature function (call for details)
- Remote refrigeration installation (call for details)
- Front & side panel colours - White printed glass  
Wood finishes
- Basement colour - 304 Stainless steel  
Black painted sheet (RAL9005)  
Castle White printed glass (RAL9003)

## Features:

- ♦ OneShow - A showcase that can do everything; gelato, frozen pastry items, ice lolly display, chilled pastries and chocolate.
- ♦ Stratified glass structures are heated to help prevent condensation build up.
- ♦ Available in a range of premium standard finished and wood effects are available on request.
- ♦ Free-standing design for maximum visual impact.



**ENERGY SAVING**  
LED lights + EC fan motor



**REFRIGERATION**  
Ventilated



**DEFROST**  
Reverse cycle - Gelato  
Off cycle - Pastry & Chocolate



**REFRIGERANT**  
R290 - 120+120  
R452A - 170+170



**INSTALLATION**  
Plug-In / Remote (optional)



**TEMPERATURE**  
-20 / +2 °C - Gelato  
+1 / +10 °C - Pastry  
+14 / +16 °C - Chocolate



**CLIMATE CLASS**  
4 - Gelato  
3 - Pastry & Chocolate



**ENERGY RATING**  
F - Gelato  
G - Pastry



Sistema di Qualità  
**ISO 9001**  
Cert. CISQ/CSQ 9130.TAIF



Sistema di Qualità  
**ISO 14001**  
Cert. CIS ECO ISO 9191.ISA3



**Taylor UK** (a division of HTG Trading Ltd)  
106 Claydon Business Park, Gt. Blakenham,  
Ipswich, Suffolk, IP6 0NL, United Kingdom  
**0800 838 896 - sales@taylor-company.co.uk**  
**www.taylor-company.co.uk**

Due to continual research and development, these specifications are subject to change without notification.

March 2021

ONESHOW BASE - High visibility free-standing display cabinets - 12/18 flavour

# ONESHOW BASE



## High visibility free-standing display cabinets

Section view: (all dimensions in mm)

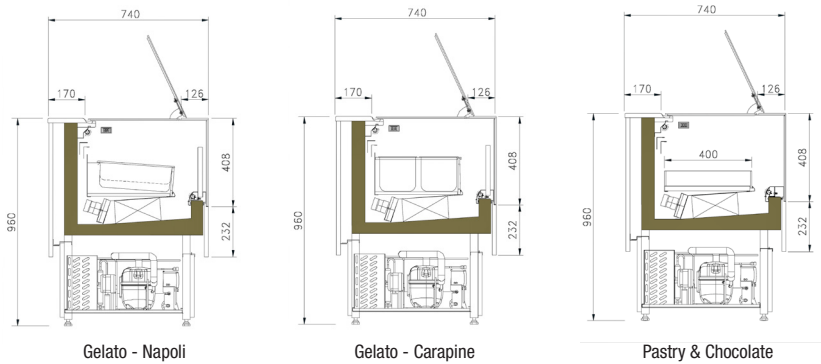

Gelato - Napoli

Gelato - Carapine

Pastry & Chocolate

Pastry & Chocolate **L120+120**

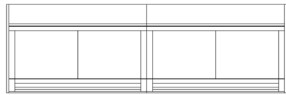

Display area - 1060 x 400 mm    Display area - 1060 x 400 mm

**L170+170**



Display area - 1565 x 400 mm    Display area - 1565 x 400 mm

ITEM No. \_\_\_\_\_

### Napoli configuration:

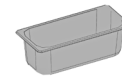

**5 Lt (STD Polycarbonate)**  
360 x 165 x 120(h) mm

#### Display

Model 120+120 6+6  
Model 170+170 9+9



**5/10 Lt (WIDE Polycarbonate)**  
360 x 250 x 80/120(h) mm

#### Display

Model 120+120 4+4  
Model 170+170 6+6

### Carapine configuration:



**3 Lt (Polycarbonate)**  
154 x 160(h) mm

#### Display

Model 120+120 10+10  
Model 170+170 16+16

Gelato - Napoli **L120+120**

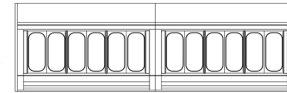

**L170+170**

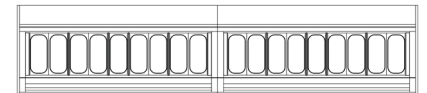

Gelato - Carapine **L120+120**

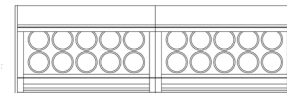

**L170+170**

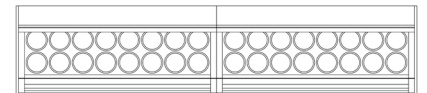

ONESHOW BASE		Model type	Display area m <sup>2</sup>	Temp class	Reccom. temp °C	Energy class	Energy Efficiency Index	Annual Energy kWh/A
Height	Length							
H96 GELATO	120+120	IGF1	0.94	G2	-15 °C	F (R290)	72.68	14,235
	170+170	IGF1	1.42	G2	-15 °C	E (R452A)	64.54	16,053
H96 PASTRY	120+120	IHC7	1.09	H	+2 °C	G (R290)	99.90	2,774
	170+170	IHC7	1.63	H	+2 °C	G (R452A)	99.70	3,478

Configuration: air cooled plug-in unit (R290 or R452A) plexiglass sliding closure, LED lighting

ONESHOW BASE*	GELATO		PASTRY		CHOCOLATE	
	RV 120+120	RV 170+170	PAS RV 120+120	PAS RV 170+170	CHOC RV 120+120	CHOC RV 170+170
External dimensions (LxDxH)	2360 x 740 x 960 mm	3370 x 740 x 960 mm	2360 x 740 x 960 mm	3370 x 740 x 960 mm	2360 x 740 x 960 mm	3370 x 740 x 960 mm
Net weight	380 kg	510 kg	380 kg	510 kg	380 kg	510 kg
Refrigeration	Ventilated					
Refrigerant	R290	R452A	R290	R452A	R290	R452A
Climate class	4			3		
Operating conditions	30 °C / 55 %RH			25 °C / 60 %RH		
Operating temperature range	-20 / +2 °C		n/a		n/a	
Product storage temperature	-16 / -14 °C		+1 / +10 °C		+14 / +16 °C	
Compressor (no. - type)	2 - Hermetic					
Defrost process	Reverse cycle			Off cycle		
Power supply voltage	230v / 50hz / 1ph					
Electrical input (nominal)	2000 w / 10.2 A	3300 w / 15.6 A	1720 w / 10.8 A	2000 w / 11.2 A	1720 w / 10.8 A	2000 w / 11.2 A
Electrical input (defrost)	3400 w / 16.0 A	7000 w / 31.2 A	140 w / 0.8 A	160 w / 0.9 A	140 w / 0.8 A	160 w / 0.9 A

**Taylor UK** (a division of HTG Trading Ltd)  
106 Claydon Business Park, Gt. Blakenham,  
Ipswich, Suffolk, IP6 0NL, United Kingdom  
**0800 838 896 - sales@taylor-company.co.uk**  
**www.taylor-company.co.uk**

Due to continual research and development, these specifications are subject to change without notification.

\*Data for air cooled units. Water cooled and remote installations are available on request.

ONESHOW BASE - High visibility free-standing display cabinets - 12/18 flavour