

STRATOS

Professional ventilated gelato display



Model RV PLUS 220 with optional Pearl White internal front panel



Customisable area:

- Model 120 - 1150 x 240 mm
- Model 170 - 1645 x 240 mm
- Model 220 - 2140 x 240 mm

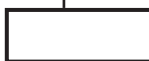

ITEM No. _____

Model options:

(PLUS - SINGLE EVAPORATOR, DUAL FRONT AIRFLOW)

- STRATOS RV PLUS 120
- STRATOS RV PLUS 170
- STRATOS RV PLUS 220



(PLUS 1 - DUAL EVAPORATOR, SINGLE REAR AIRFLOW)

- STRATOS RV PLUS 1 120
- STRATOS RV PLUS 1 170
- STRATOS RV PLUS 1 220



(PLUS 2 - DUAL EVAPORATOR, DUAL REAR AIRFLOW)

- STRATOS RV PLUS 2 120
- STRATOS RV PLUS 2 170
- STRATOS RV PLUS 2 220



Standard equipment:

- Cool white LED lighting 5700 K°
- Work top - Glacier White Corian™
- Front panel - White Pearl (RAL1013)
- Internal front panel - Black (RAL9005)
- Side panels - White Pearl (RAL1013)
- Plexiglass sliding doors
- Adjustable air deflectors (PLUS 1&2 ONLY)
- Swivel castors with brake & adjustable feet

Optional extras:

- 5 ltr standard napoli (S/S)
- 5 ltr wide napoli (S/S) (360x250x80h mm)
- Self rolling night curtain
- One unrefrigerated shelf above display
- Cone holder with/without toppings container
- Scoop wash with shower or tap
- Ice lolly container (250x360x43h mm)
- Tray for individual portions (250x360 mm)
- Dual temperature function (call for details)
- Remote refrigeration installation (call for details)
- Custom RAL panel colours (call for details)
- White Pearl internal front panel (RAL1013)
- Black side panels (RAL9005)

Features:

- ♦ Stratos is the new high-end display cabinet from ISA which combines maximum technical performance with aesthetics that fully reflect the elegance and unmistakable style of Italian design.
- ♦ Stratos can be set up with three different types of ventilation: PLUS single evaporator with frontal dual airflow; PLUS 1 dual evaporator with single rear air flow; PLUS 2 dual evaporator with dual rear air flow.
- ♦ Stratos has front and side glass windows with heated chamber and a heatable laminated upper glass with servo assisted manual opening.



ENERGY SAVING
LED lights + EC fan motor



REFRIGERATION
Ventilated



DEFROST
Reverse cycle



REFRIGERANT
R404A



INSTALLATION
Plug-In / Remote (optional)



TEMPERATURE
-20 / +2 °C



CLIMATE CLASS
7 - PLUS
4 - PLUS 1 & PLUS 2



Taylor UK (a division of HTG Trading Ltd)
106 Claydon Business Park, Gt. Blakenham,
Ipswich, Suffolk, IP6 0NL, United Kingdom
0800 838 896 - sales@taylor-company.co.uk
www.taylor-company.co.uk

Due to continual research and development, these specifications are subject to change without notification - June 2019

STRATOS – Professional ventilated gelato display - 12/18/24 flavour

STRATOS



Professional ventilated gelato display

Section view: (all dimensions in mm)

H125



PLUS

Single evaporator
with frontal dual airflow
Display inclination 11°

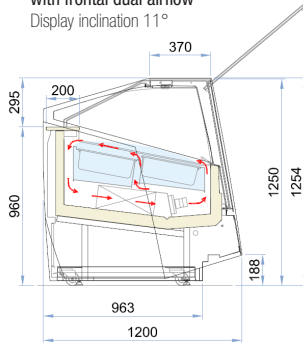

PLUS 1

Dual evaporator
with single rear airflow
Display inclination 3°

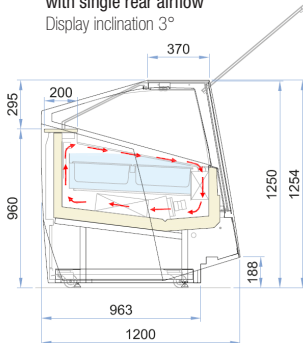

PLUS 2

Dual evaporator
with dual rear airflow
Display inclination 0°

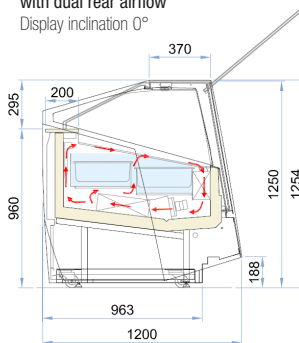

ITEM No. _____

Napoli configuration:

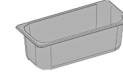

5 ltr (STD)
360 x 165 x 120(h) mm

Display

Model 120
Model 170
Model 220

12
18
24

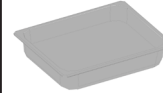

5 ltr (WIDE)
360 x 250 x 80(h) mm

Display

Model 120
Model 170
Model 220

8
12
16

STRATOS*	RV 120	RV 170	RV 220
External dimensions (LxDxH)	1190 x 1200 x 1254 mm	1685 x 1200 x 1254 mm	2180 x 1200 x 1254 mm
Net weight	400 kg	460 kg	510 kg
Refrigeration	Ventilated		
Refrigerant	R404A		
Climate class - PLUS	7		
Climate class - PLUS 1 & 2	4		
Operating conditions - PLUS	35 °C / 75 %RH		
Operating conditions - PLUS 1 & 2	30 °C / 55 %RH		
Operating temperature range	-20 / +2 °C		
Product storage temperature	-16 / -14 °C		
Compressor (no. - type)	1 - Hermetic	2 - Hermetic	
Defrost process	Reverse cycle		
Power supply voltage	230v / 50hz / 1ph	400v / 50hz / 3ph	
Electrical input (nominal)	1240 w / 6.0 A	1720 w / 3.0 A	2700 w / 4.2 A
Electrical input (defrost)	2300 w / 11.0 A	2950 w / 4.9 A	6300 w / 8.5 A

*Data for air cooled units. Water cooled and remote installations are available on request.



Sistema di Qualità
ISO 9001
Cert. CISQ/CISQ 9130.TAIF



Sistema di Qualità
ISO 14001
Cert. CIS ECO ISO 9191.ISA3



Taylor_{UK}
Catering Equipment Specialists

Taylor UK (a division of HTG Trading Ltd)
106 Claydon Business Park, Gt. Blakenham,
Ipswich, Suffolk, IP6 0NL, United Kingdom
0800 838 896 - sales@taylor-company.co.uk
www.taylor-company.co.uk

Due to continual research and development, these specifications are subject to change without notification - June 2019