

# SUPERCAPRI

Professional ventilated gelato display



Model RV PLUS 220 H117



Model RV PLUS 220 H117

Customisable area:

- Model 120 - 1152 x 440 mm
- Model 170 - 1647 x 440 mm
- Model 220 - 2142 x 440 mm

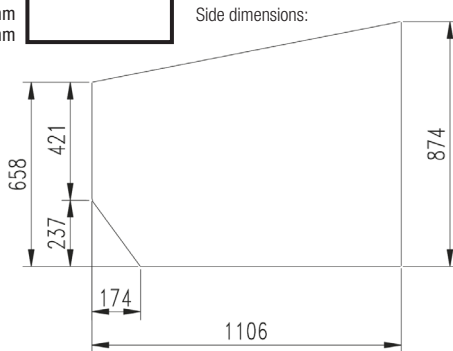

ITEM No. \_\_\_\_\_

Model options:

- (PLUS - SINGLE EVAPORATOR, DUAL FRONT AIRFLOW)
  - SUPERCAPRI RV PLUS 120
  - SUPERCAPRI RV PLUS 170
  - SUPERCAPRI RV PLUS 220
- (PLUS 1 - DUAL EVAPORATOR, SINGLE REAR AIRFLOW)
  - SUPERCAPRI RV PLUS 1 120
  - SUPERCAPRI RV PLUS 1 170
  - SUPERCAPRI RV PLUS 1 220
- (PLUS 2 - DUAL EVAPORATOR, DUAL REAR AIRFLOW)
  - SUPERCAPRI RV PLUS 2 120
  - SUPERCAPRI RV PLUS 2 170
  - SUPERCAPRI RV PLUS 2 220



ALL models listed above are available either H117 or H135 high

Standard equipment:

- Cool white LED lighting 5700 K°
- Work top - Glacier White Corian™
- Front panel - Grey (RAL7022) laquered
- Lower front grill - Grey (RAL7022) laquered
- Side panels - Grey (RAL7022) laquered
- Plexiglass sliding doors
- Adjustable air deflectors (PLUS 1&2 ONLY)
- Swivel castors with brake & adjustable feet

Optional extras:

- 5 ltr standard napoli (S/S)
- 5 ltr wide napoli (S/S) (360x250x80h mm)
- Cone holder with/without toppings container
- Scoop wash with shower or tap
- Ice lolly container (250x360x43h mm)
- Tray for individual portions (250x360 mm)
- Self rolling night curtain
- Dual temperature function (call for details)
- Remote refrigeration installation (call for details)
- Custom RAL panel colours (call for details)
- Front & side panel colours - White Laquer (RAL9003)  
Black Laquer (RAL9005)

Features:

- ◆ Supercapri is the synthesis of an essential design and high-level technical features. It is equipped with glass side windows with heated chamber and heatable laminated front glass that can be opened.
- ◆ Supercapri can be set up with three different types of ventilation: PLUS single evaporator with frontal dual airflow; PLUS 1 dual evaporator with single rear air flow; PLUS 2 dual evaporator with dual rear air flow.



**ENERGY SAVING**  
LED lights + EC fan motor



**REFRIGERATION**  
Ventilated



**DEFROST**  
Reverse cycle



**REFRIGERANT**  
R404A



**INSTALLATION**  
Plug-In / Remote (optional)



**TEMPERATURE**  
-20 / +2 °C



**CLIMATE CLASS**  
7 - PLUS  
4 - PLUS 1 & PLUS 2



**Taylor UK** (a division of HTG Trading Ltd)  
106 Claydon Business Park, Gt. Blakenham,  
Ipswich, Suffolk, IP6 0NL, United Kingdom  
**0800 838 896 - sales@taylor-company.co.uk**  
**www.taylor-company.co.uk**

Due to continual research and development, these specifications are subject to change without notification - June 2019

SUPERCAPRI - Professional ventilated gelato display - 12/18/24 flavour

# SUPERCAPRI



## Professional ventilated gelato display

Section view: (all dimensions in mm)

### H117

Single evaporator with frontal dual airflow  
**PLUS** Display inclination 11°

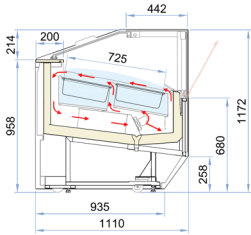

Dual evaporator with single rear airflow  
**PLUS 1** Display inclination 3°

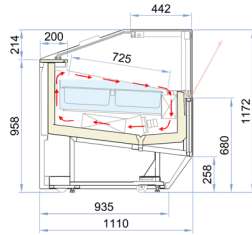

Dual evaporator with dual rear airflow  
**PLUS 2** Display inclination 0°

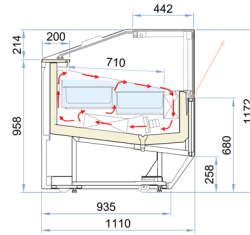

### H135

**PLUS**

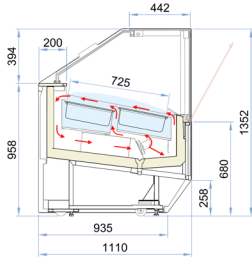

**PLUS 1**

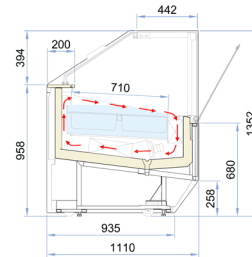

**PLUS 2**

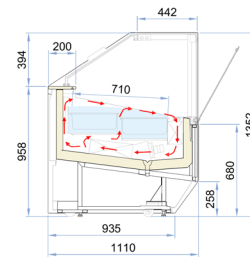

ITEM No. \_\_\_\_\_

Napoli configuration:

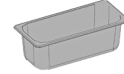

**5 ltr (STD)**  
360 x 165 x 120(h) mm

**Display**

Model 120  
Model 170  
Model 220

12  
18  
24

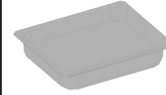

**5 ltr (WIDE)**  
360 x 250 x 80(h) mm

**Display**

Model 120  
Model 170  
Model 220

8  
12  
16

SUPERCAPRI*	RV 120	RV 170	RV 220
External dimensions (LxDxH) <b>H117</b>	1187 x 1110 x 1175 mm	1682 x 1110 x 1175 mm	2177 x 1110 x 1175 mm
External dimensions (LxDxH) <b>H135</b>	1187 x 1110 x 1352 mm	1682 x 1110 x 1352 mm	2177 x 1110 x 1352 mm
Net weight <b>H117</b>	320 kg	409 kg	510 kg
Net weight <b>H135</b>	346 kg	434 kg	535 kg
Refrigeration	Ventilated		
Refrigerant	R404A		
Climate class - <b>PLUS</b>	7		
Climate class - <b>PLUS 1 &amp; 2</b>	4		
Operating conditions - <b>PLUS</b>	35 °C / 75 %RH		
Operating conditions - <b>PLUS 1 &amp; 2</b>	30 °C / 55 %RH		
Operating temperature range	-20 / +2 °C		
Product storage temperature	-16 / -14 °C		
Compressor (no. - type)	1 - Hermetic	2 - Hermetic	
Defrost process	Reverse cycle		
Power supply voltage	230v / 50hz / 1ph	400v / 50hz / 3ph	
Electrical input (nominal)	1240 w / 6.0 A	1720 w / 3.0 A	2700 w / 4.2 A
Electrical input (defrost)	2300 w / 11.0 A	2950 w / 4.9 A	6300 w / 8.5 A

\*Data for air cooled units. Water cooled and remote installations are available on request.



**Taylor UK** (a division of HTG Trading Ltd)  
106 Claydon Business Park, Gt. Blakenham,  
Ipswich, Suffolk, IP6 0NL, United Kingdom  
**0800 838 896 - sales@taylor-company.co.uk**  
**www.taylor-company.co.uk**

Due to continual research and development, these specifications are subject to change without notification - June 2019